



The New-Qala

Guiding Informal Settlements with Traditional Structures

A Summary

Sandi Lin
Tamam Mango
Dinsha Mistree
Atif Qadir

Goals

- Short term: Meet immediate needs of incoming refugees through New Qalas development
- Medium term: Provide stability by providing basic infrastructure
- Long term: Rebuild the Green City



The Afghani Qala

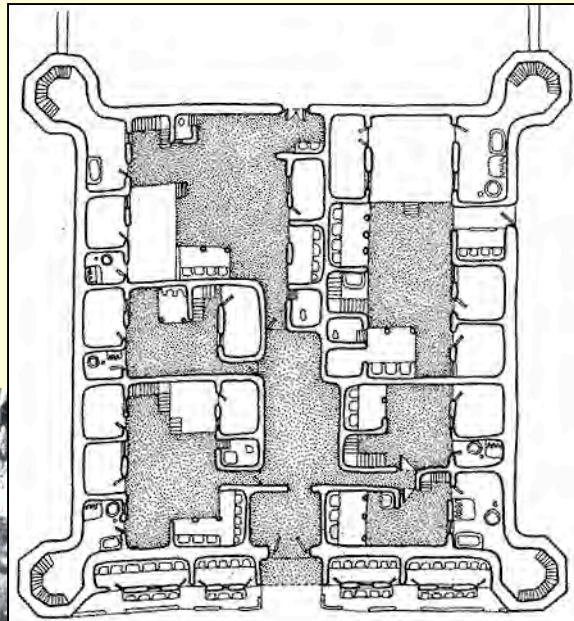

A traditional Afghani
fortress-dwelling
offering:

- Community
- Security
- Subsistence

Plan of qala in Maidan
Valley holding six
dwellings
From *Qala: The Fortress
Home*

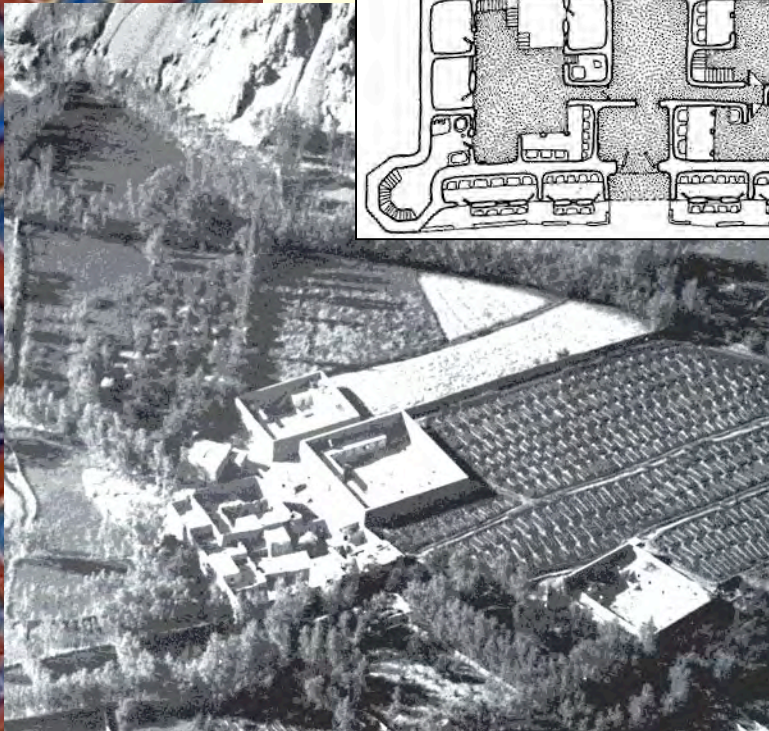

The New-Qala Concept

All distances in meters

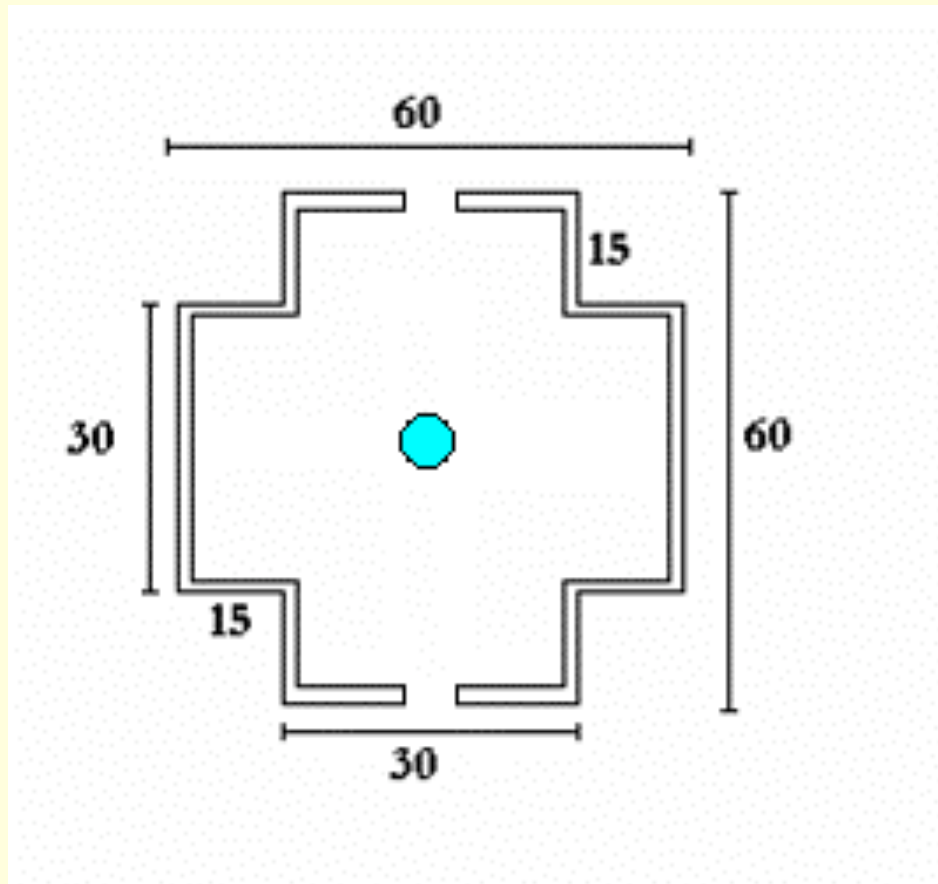

- Provides community, security, subsistence, identity and flexibility
- Surrounded by an exterior wall with water standpipe in center
- Houses up to 30 families

The New-Qala: Components

All distances in meters

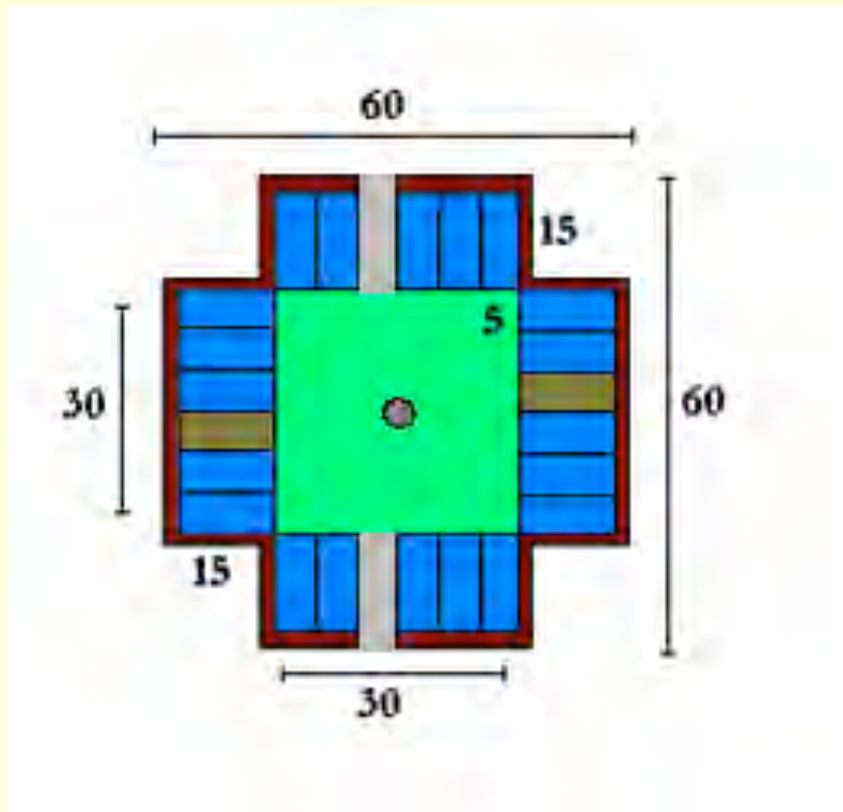

KEY

- Initial wall
- Water pump
- Dwelling
- Animal place
- Inner courtyard central space

- Central space for garden plots or general communal space
- Central standpipe provides easy access to water

Organizing the New-Qalas

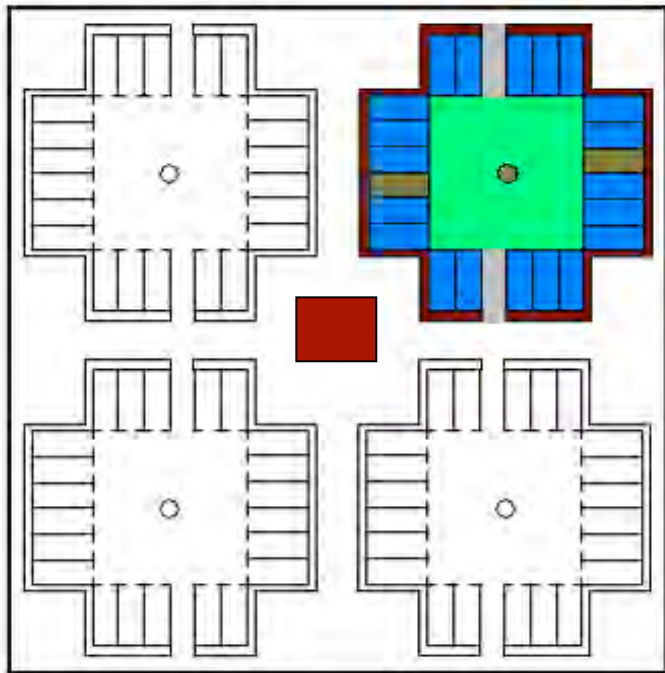



- New-Qalas are administered in groups of four
- NGO provides assistance and organizes the settlement in a temporary building at center
- Central flagpole indicates availability of plots!

The Community Emerges

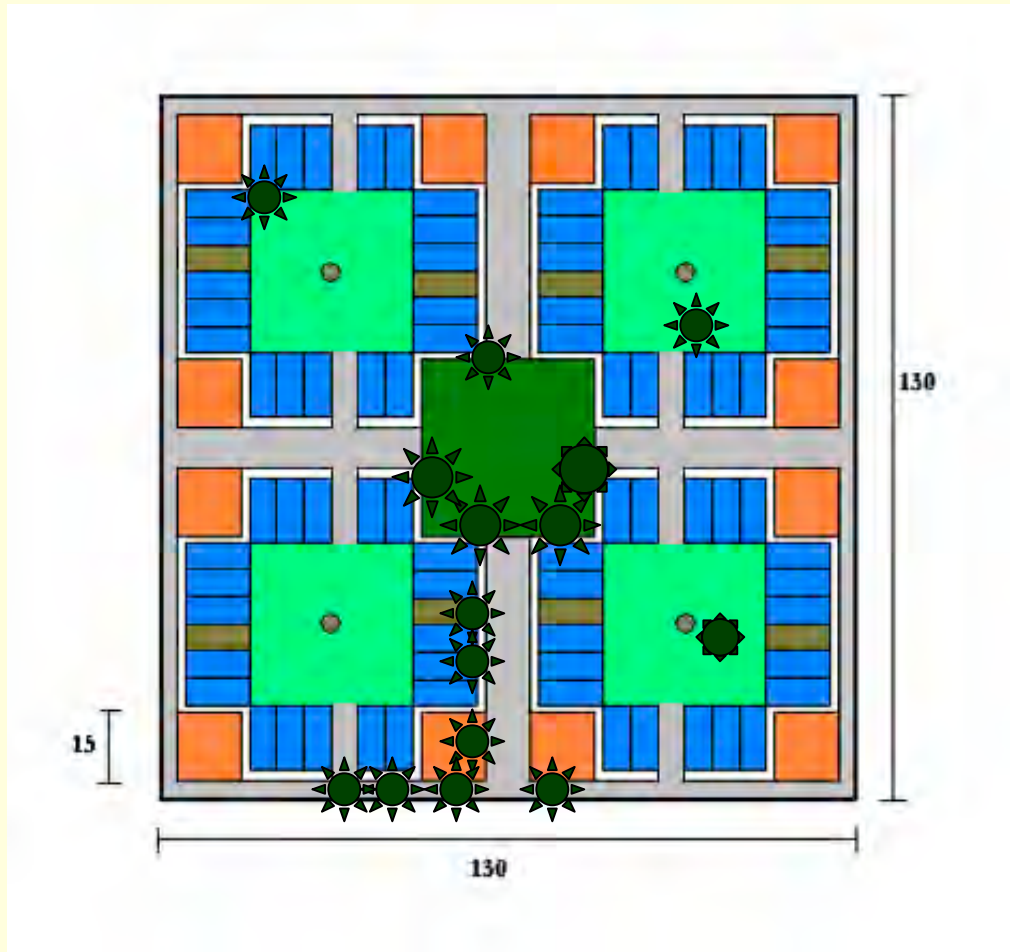
All distances in meters

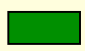

-  Four Qala courtyard provides space for neighborhood facilities
-  “Market” areas provide cost-subsidy potential
-  Trees encourage identity and definition

The Eight Qala Block

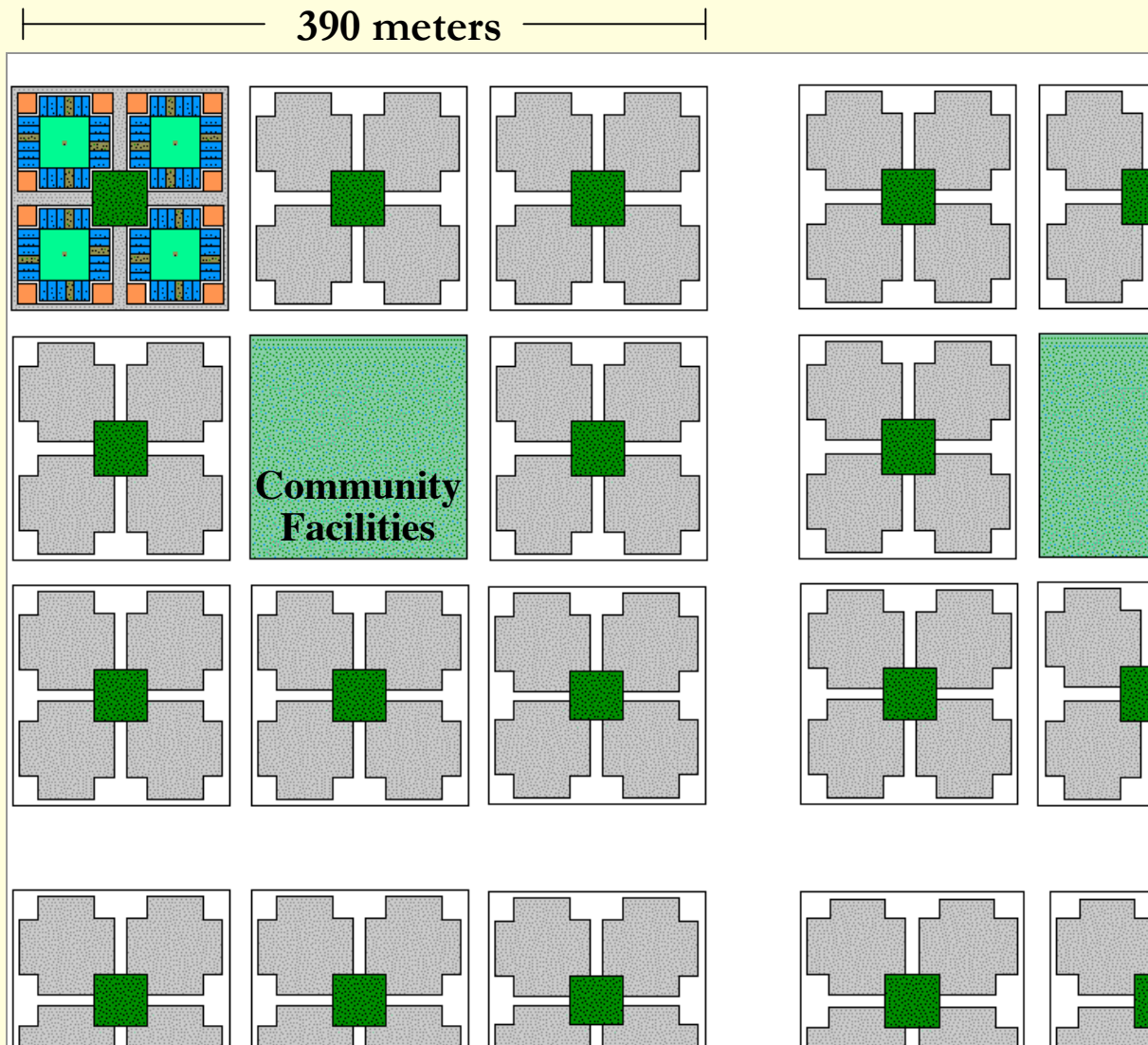

■ Block courtyard

- Eight 4-qala units comprise a city block of 3800 people

- The block is surrounded by major streets

- Central space used for schools, parks, clinics, etc.

Forming an urban structure

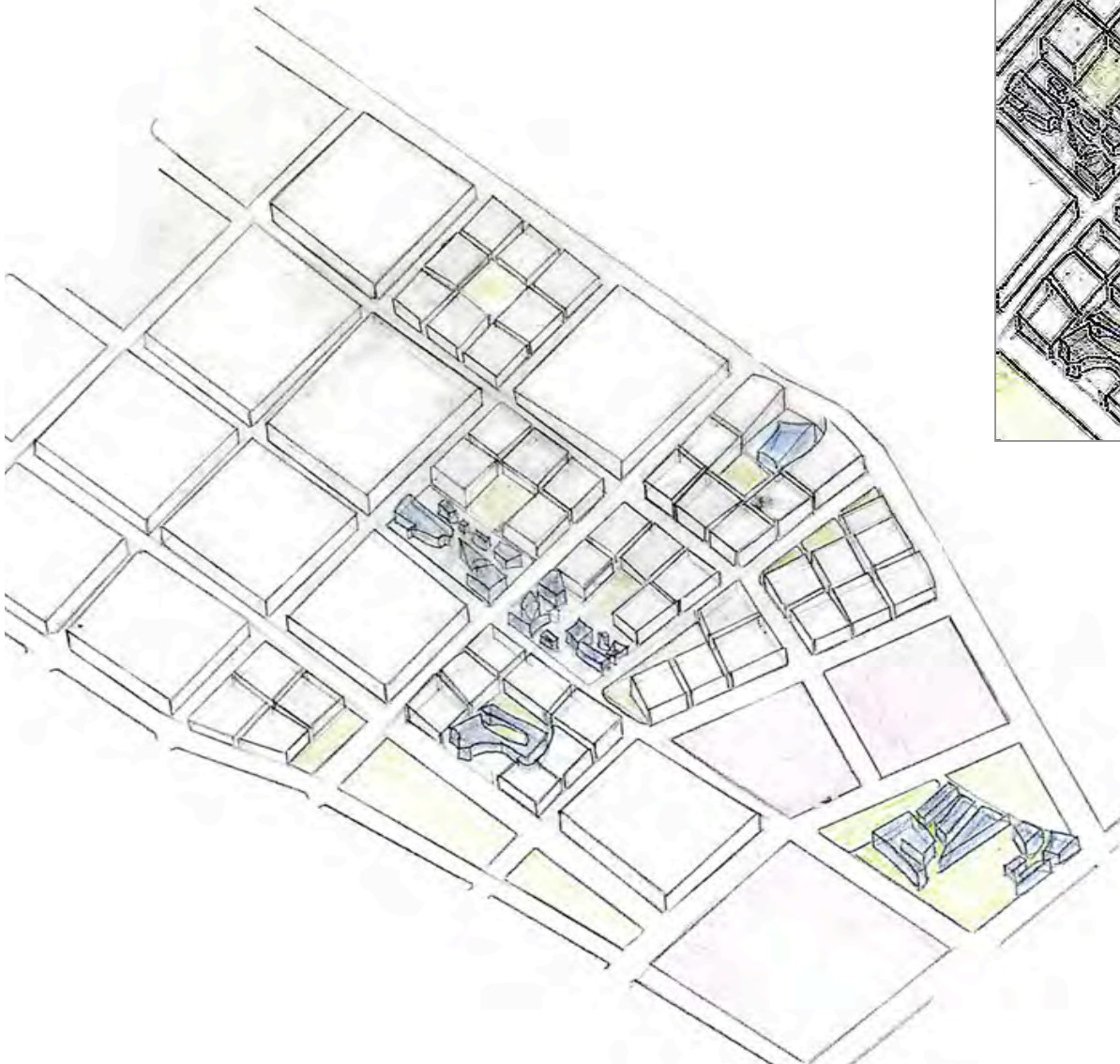

**New Qalas readily
adjust to varied site
situations**
Adaptable in:

- *Plot size*
- *Courtyard size*
- *Functions*

Summary

- New-Qalas build upon Afghan traditions
- Qalas offer immediate support and assistance to returnees and displaced families
- Design adaptable to different needs
- Families retain control over their own homes. Responsibility remains within community
- New Qalas provide cost effective development structure (*240 m²/Ha land development index*)



Q: Will families accept New-Qala concept? Can New-Qalas incorporate 'modern' demands?

